



# **TAMPA BAY EXPRESS**

A NEW CHOICE FOR A BETTER COMMUTE

Port Tampa Bay Maritime Industries  
Association

June 28, 2016

Florida Department of Transportation,  
District Seven





# More than just express lanes

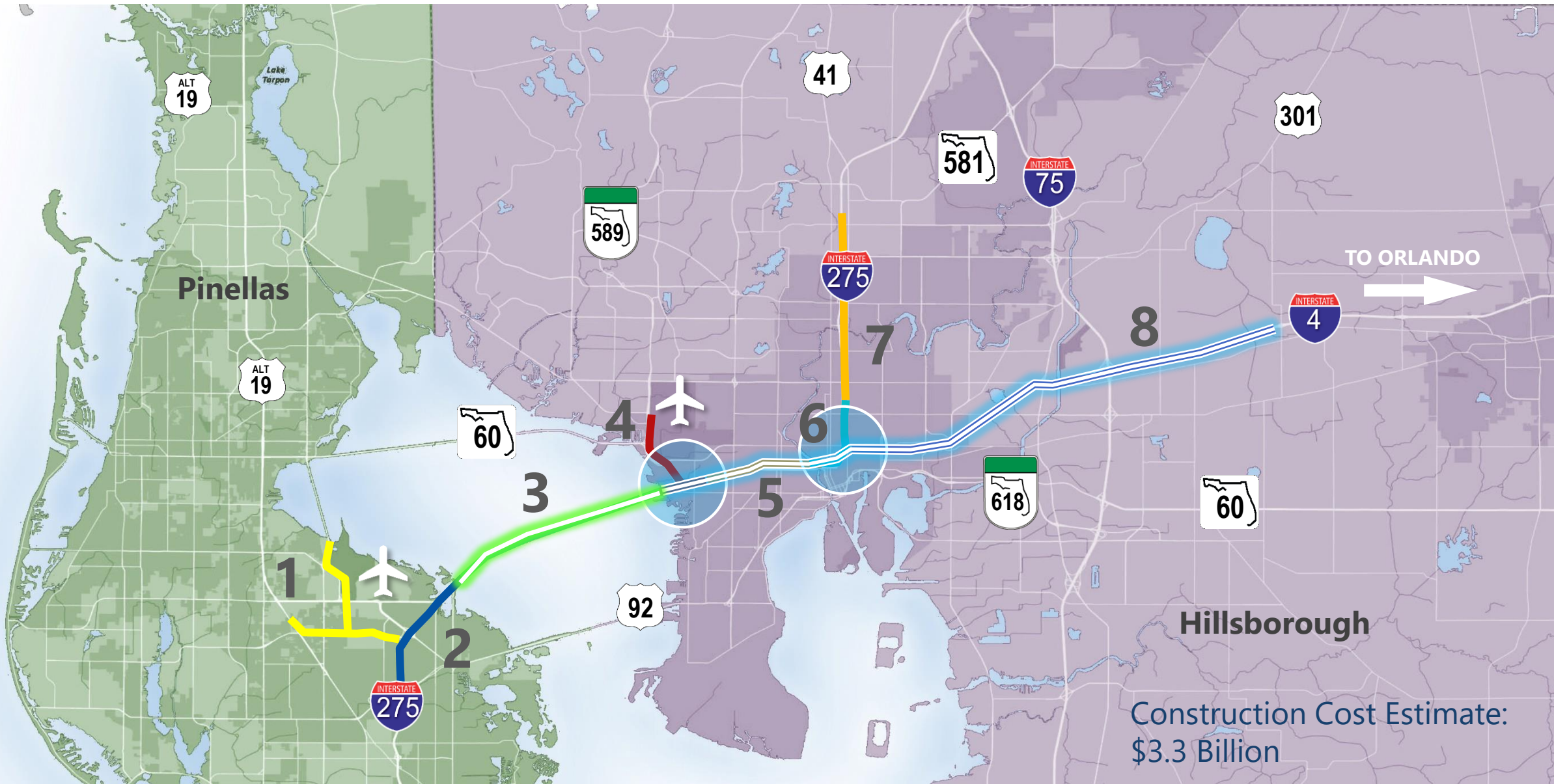

# What will TBX do?



A choice  
for drivers



Travel-time  
reliability



Transit  
Options



Safety



# Regional connectivity





# Economic growth



Florida's largest cargo tonnage port

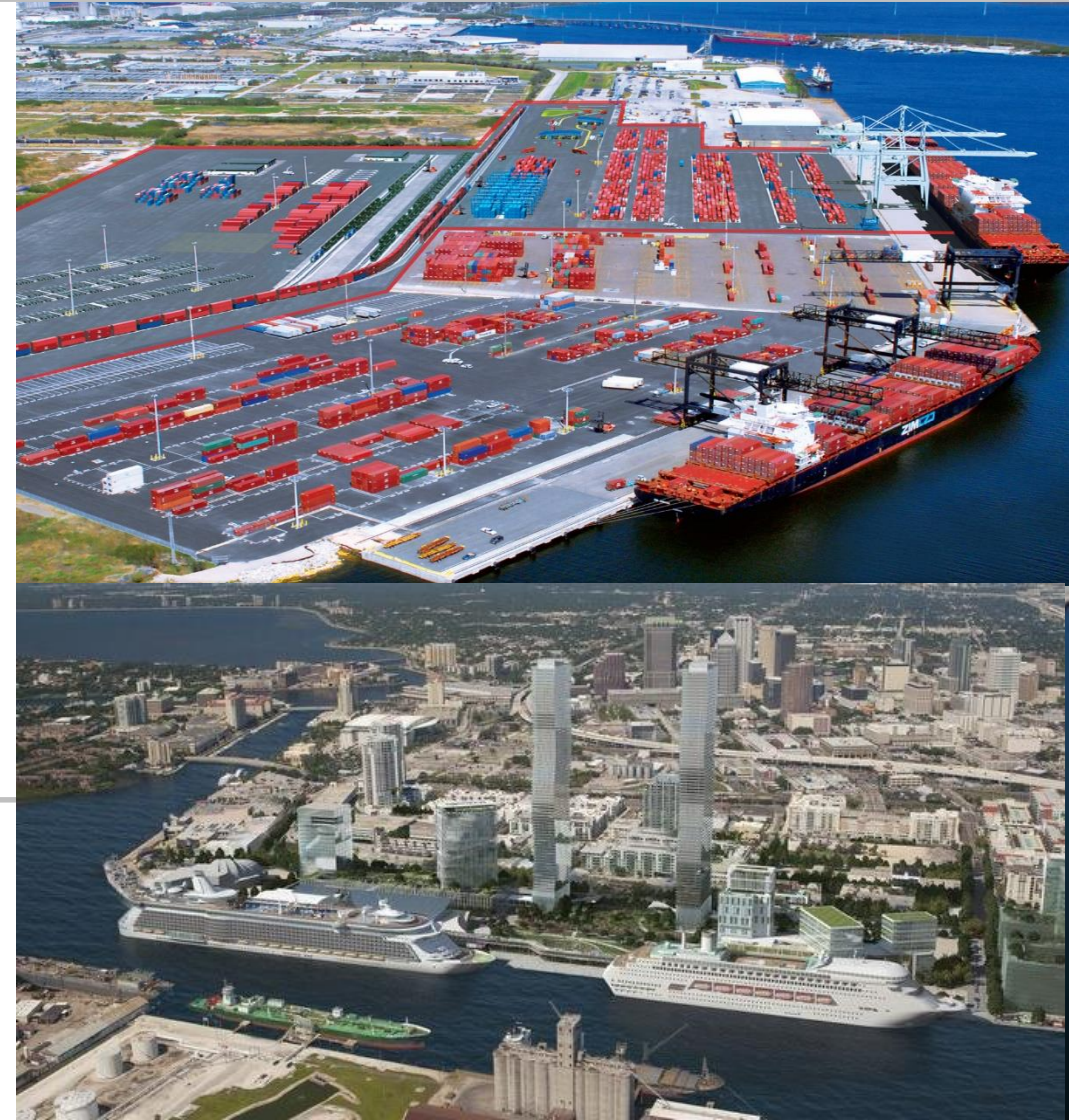



# Fostering international mobility



"Best airport in the western hemisphere  
at attracting new airlines and new destinations"





# How does it work?





# Access Points

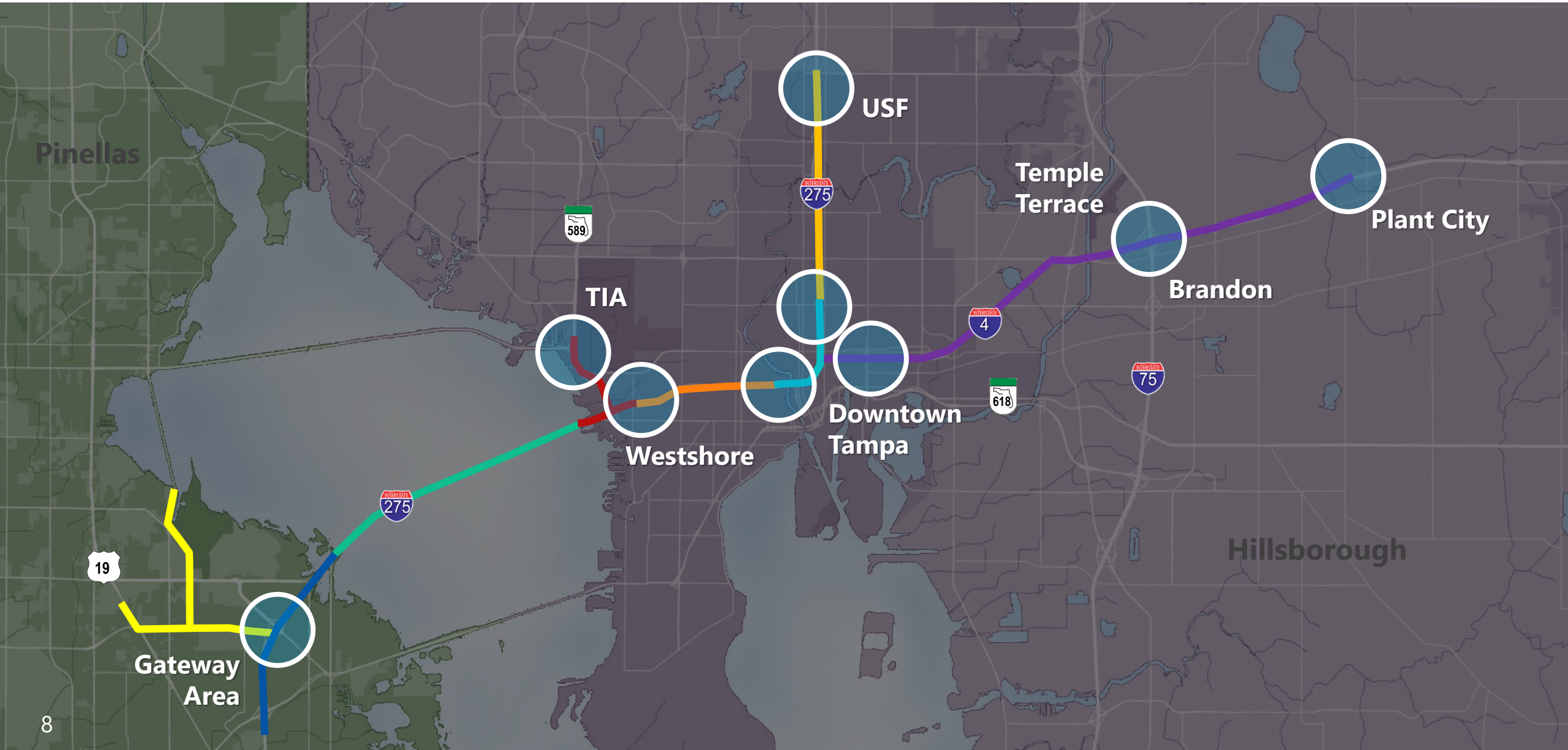



# Community Commitments

Sound Walls

Urban Design Guidelines

Historic Preservation

Tampa Heights Greenway

Bicycle and Pedestrian

Construction Techniques

Multimodal Center

HART North Terminal\*

Parks and Rec Facilities\*

*\*Fulfilled or no longer applicable.*





# Urban Design Guidelines

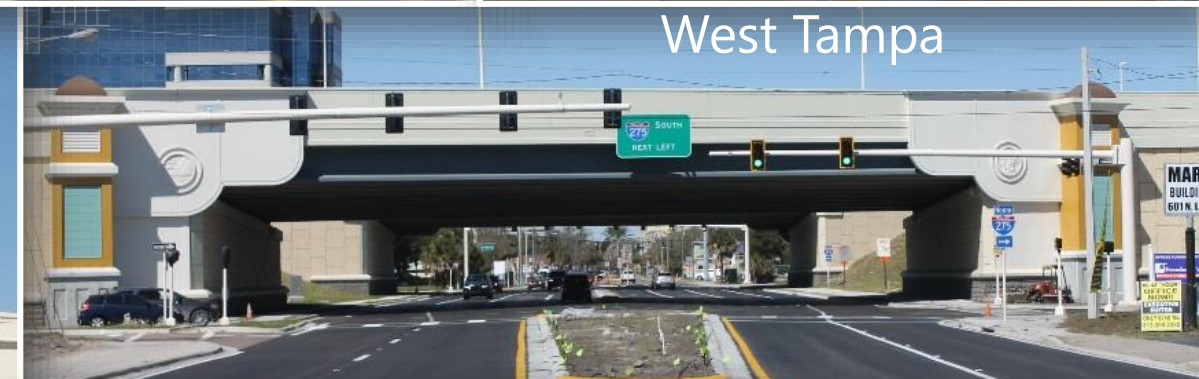



# Historic Preservation

Before



During



After





# Historic Preservation

After

Before



Interior  
Renovations





# Historic Preservation

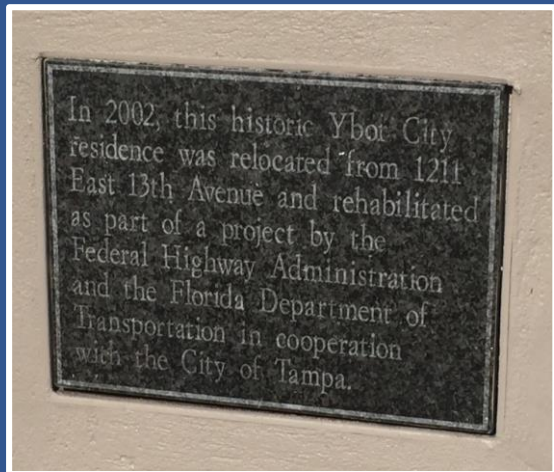

## DOT Bringing New Life To Old Ybor City Houses



Tribune photo by JAY CONNER

As part of its Interstate 4 expansion, the Florida Department of Transportation has bought and moved 33 houses in Ybor City. It plans to have all of them renovated by July 2004.

### 33 STRUCTURES MOVED, BEING RENOVATED

By SHANNON BEHNKEN  
sbehnken@tampatrib.com

**YBOR CITY**—When Interstate 4 plowed through neighborhoods four decades ago, much of the historic fabric of Ybor City was destroyed.

Bungalows were bulldozed and the neighborhood where cigar workers lived was divided by the highway.

But now that the Florida Department of Transportation is back to widen I-4, it wants to make things right, highway planner Elaine Illes said.

It bought and moved 33 houses in Ybor City. Seven have been restored, and two of those are under contract to be sold. Another seven houses are under construction and the rest will be restored by July 2004.

It is the first time the DOT has undertaken such a preservation project.

The Federal Highway Administration approved \$8 million to move and renovate the houses in an effort to protect Ybor's National Historic Landmark District.

In another unprecedented move, the DOT agreed to deed

See **HISTORIC HOUSES**, Page 16 ►  
*Renovations match the originals.*





# Tampa Heights Greenway

Tampa Heights Greenway  
from Columbus Avenue to  
Waterworks Park

Connecting gaps through  
Westshore Business District  
in partnership with City of  
Tampa

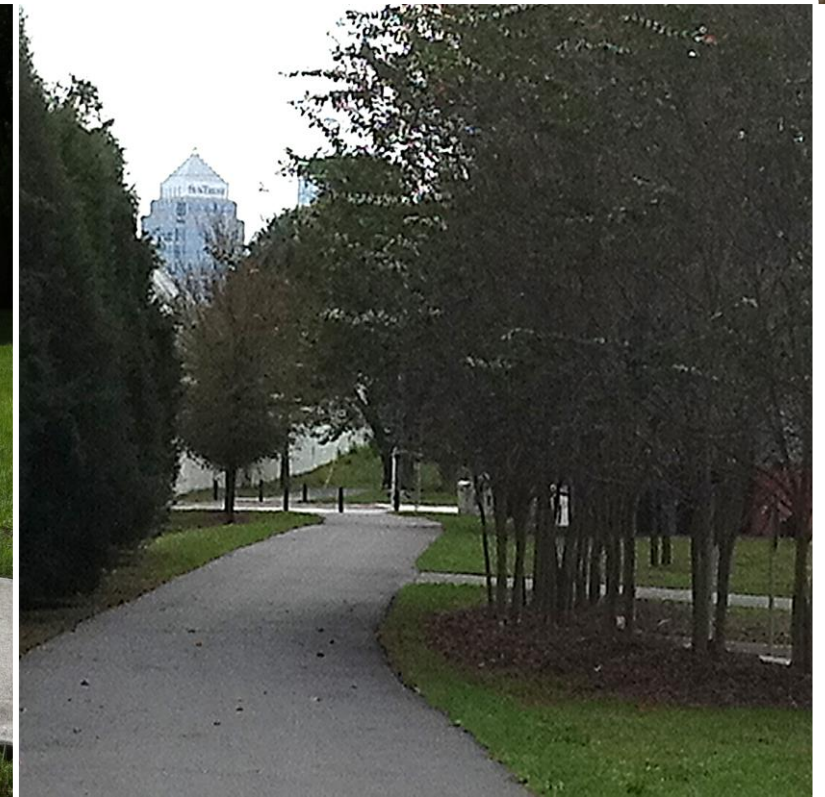



# Multimodal Center

Downtown Tampa – Former  
Morgan Street Jail property  
(2006)

Westshore Business District –  
Double Tree Hotel and  
Charley's Steakhouse  
properties (2015)

Downtown Tampa  
Multimodal Center

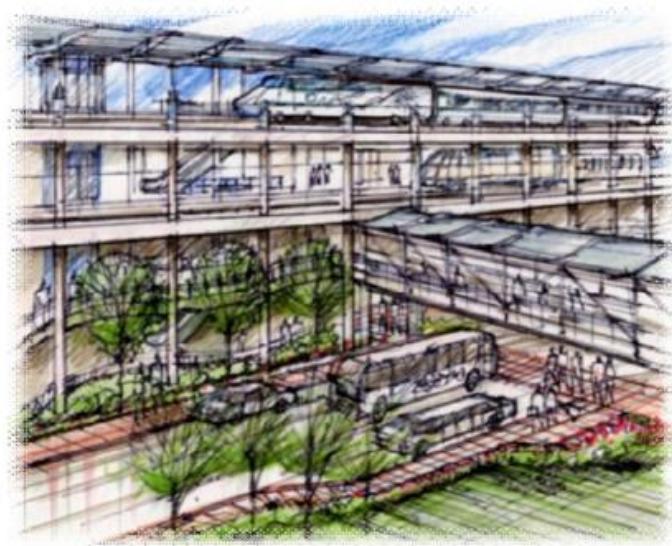

Westshore Multimodal Center



Westshore Public Realm Master Plan





# Reconnecting communities





# In Westshore





# In Downtown Tampa

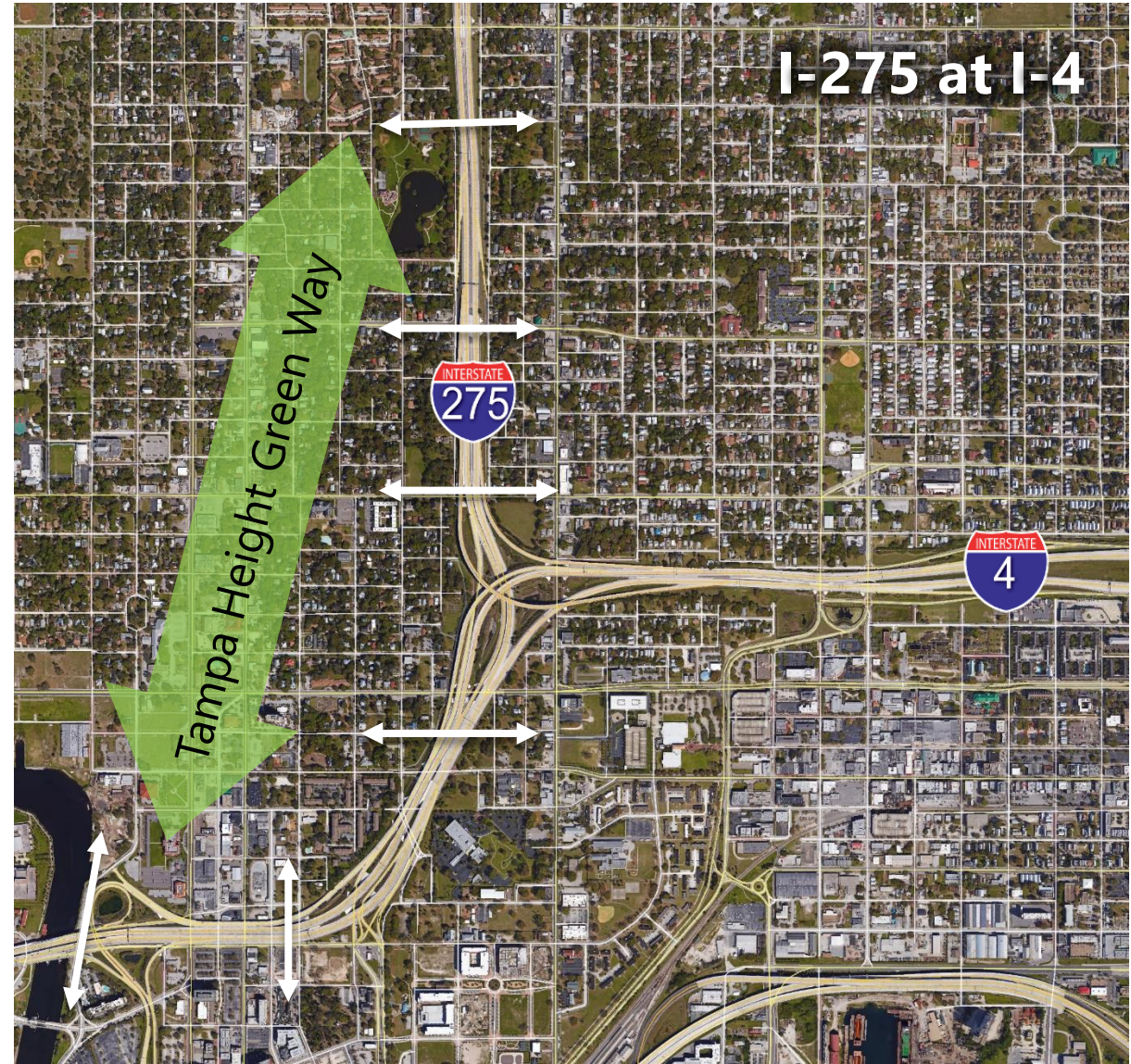



# Street Corridor Design

## Overpass Improvements

Structural Modifications  
(Straight vs Slanted Walls)

Bicycle/Pedestrian  
Amenities

Lighting  
Landscaping



*\*Artist's Renderings*



# Public Realm Enhancements

Underpass plaza between northern downtown and Tampa Heights

Connectivity between Downtown Tampa and Tampa Heights neighborhoods

Recreation, public art, and commercial opportunities

Economic Development Opportunity

Every Place Counts



*\*Artist's Renderings*



# Public Realm Enhancement-Examples



Orlando



Existing Conditions



Proposed Underpass Park Concept



Jacksonville



Artists Weekend Market



Miami



Existing Conditions

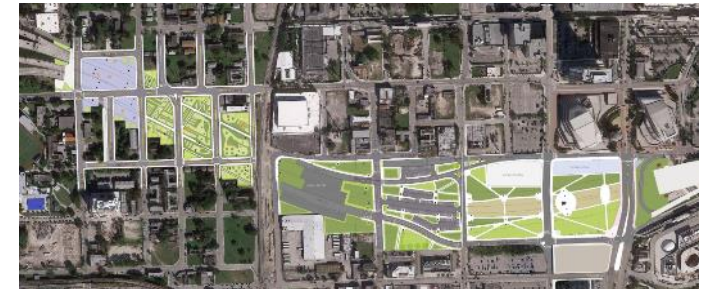

Proposed Underpass Park Concept



# Public Realm Enhancements

New E-W connection  
between Robles Park  
and Borrell Park

FDOT stormwater pond  
as community feature

Vehicle and  
bicycle/pedestrian  
connection

Landscaping





# Transit Options



## Enhanced routes during TBX construction

**Cost Estimate**  
\$10 Million

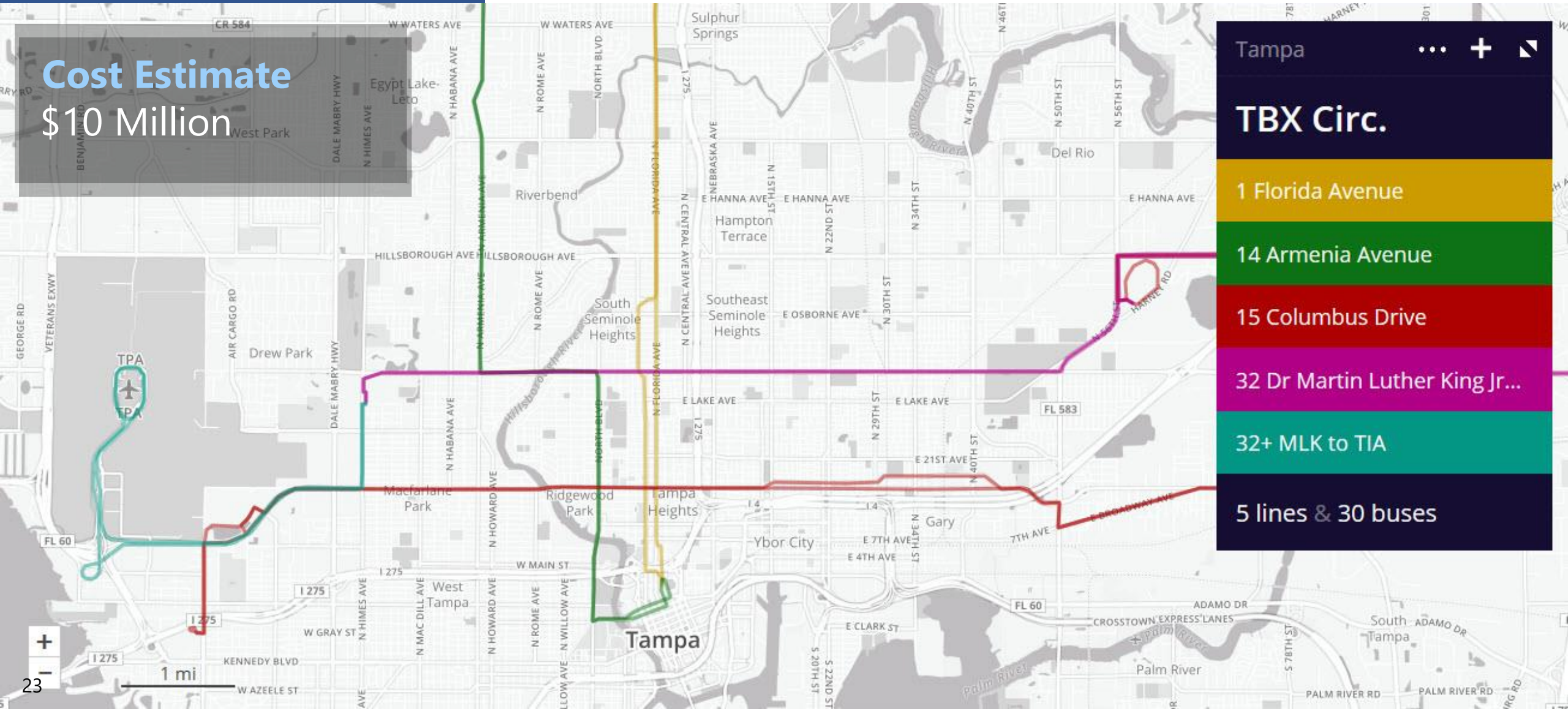

Tampa

**TBX Circ.**

1 Florida Avenue

14 Armenia Avenue

15 Columbus Drive

32 Dr Martin Luther King Jr...

32+ MLK to TIA

5 lines & 30 buses



# Investment in the Port Tampa Bay



Port Redwing  
East Port Development  
Hookers Point Container Yard  
Gantry Cranes  
Master Plan Update  
Gateway Rail Facility  
Petroleum Facility

\$100M in state funding since 2012





# Stay Involved

## Ongoing

### Local Outreach Office

Tampa Utilities Department (Former German-American Club)

Monday – Friday, 10:00am-6:00pm

Robert W. Saunders Library

Saturdays thru June 30, 10:00am-1:00pm (resume Fall 2016)

Small Group Presentations

Agency Coordination Meetings

## Aug 2016

Community Engagement Workshop

## Sept 2016

Library Tour-Round 2

Public Hearing for Section 3

## Oct 2016

Public Hearings for Sections 4, 5, and 7

[www.tampabayexpress.com](http://www.tampabayexpress.com)



**@myFDOT\_Tampa**



**FDOT  
District 7**



**FDOT West  
Central-Tampa  
Area**



# ***QUESTIONS?***



***Safety doesn't happen by accident.***



# Congestion will get worse





# Congestions costs





# Our region is growing

## Population 2010 / 2040

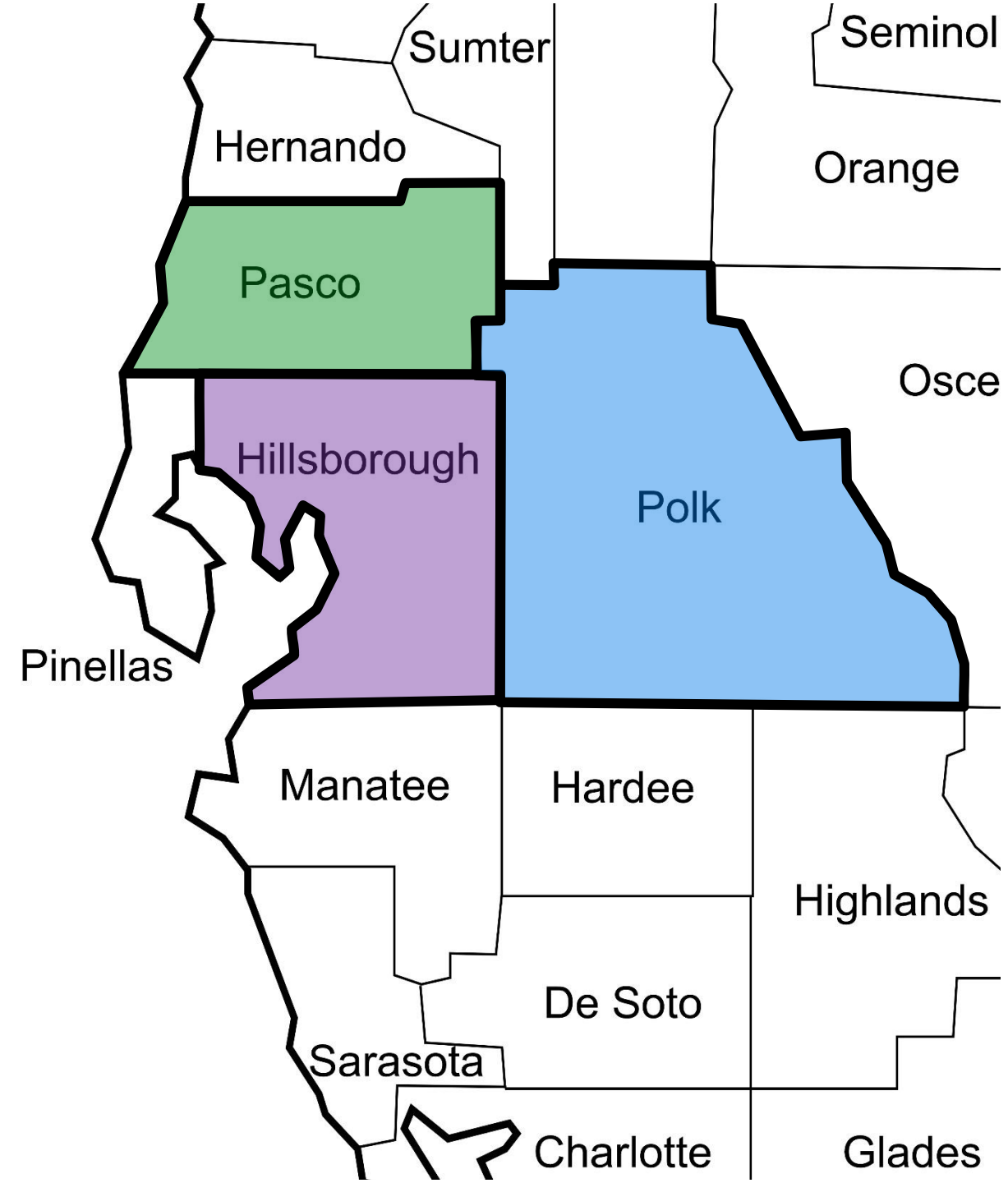
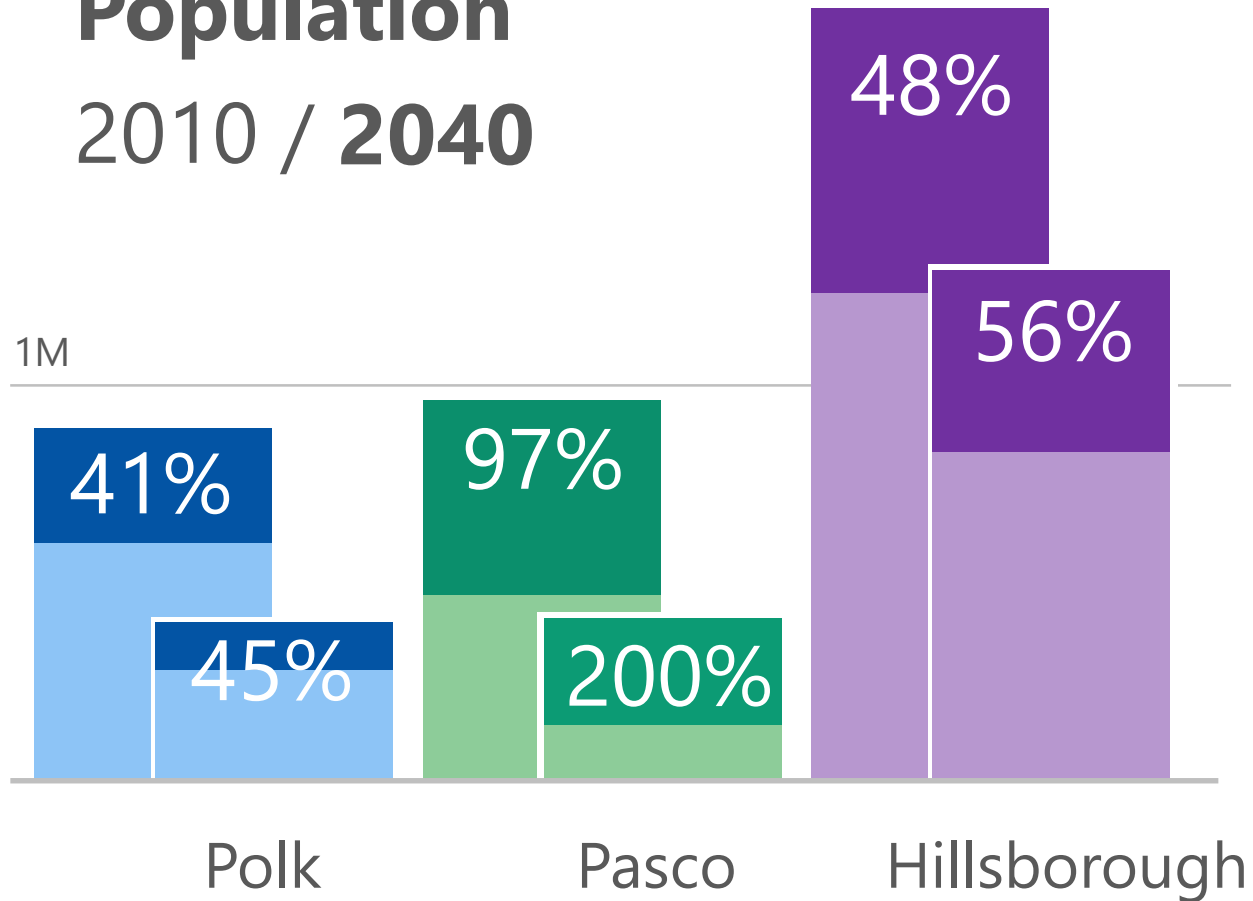



# Our region is growing

## Employment 2010 / 2040

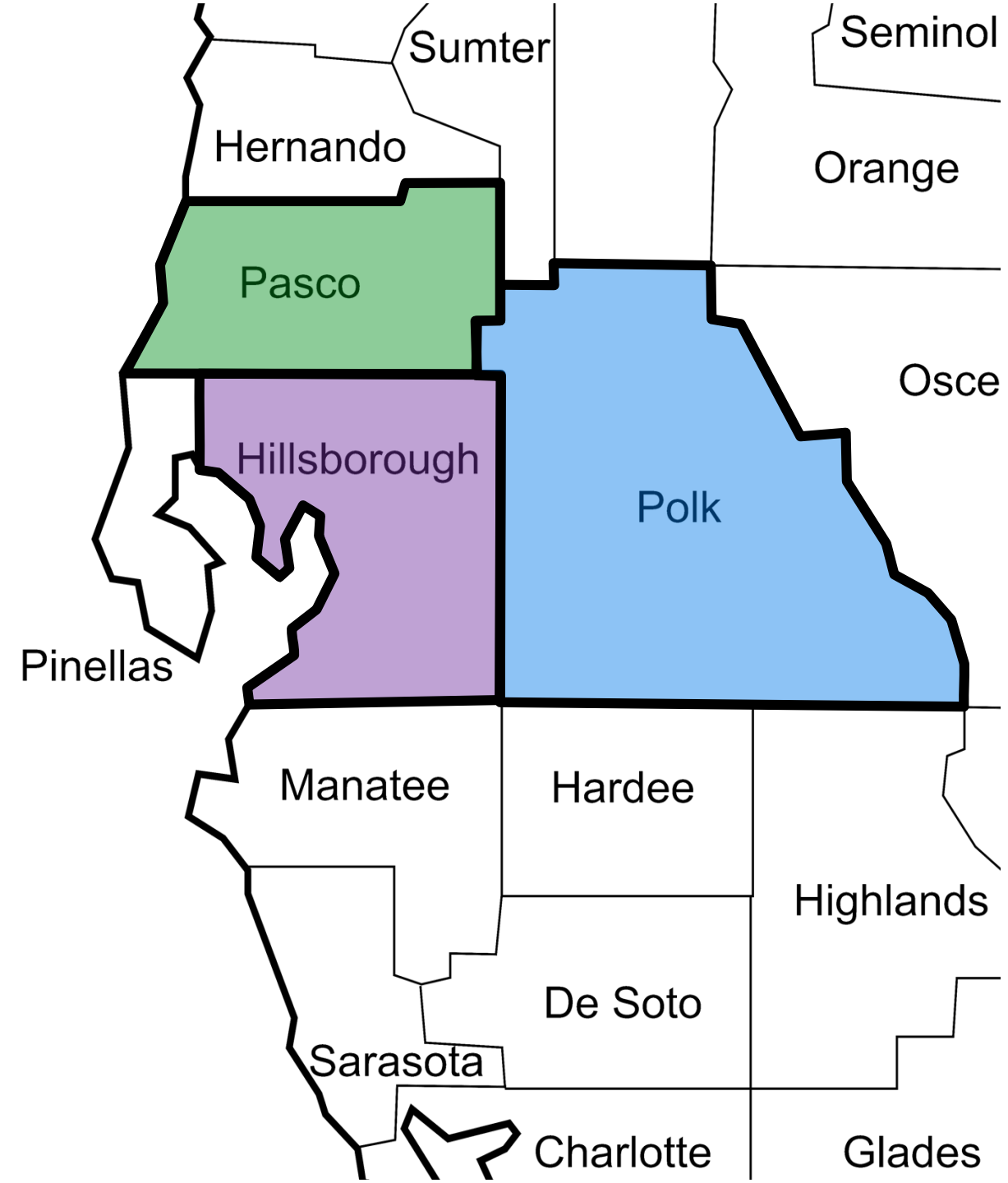
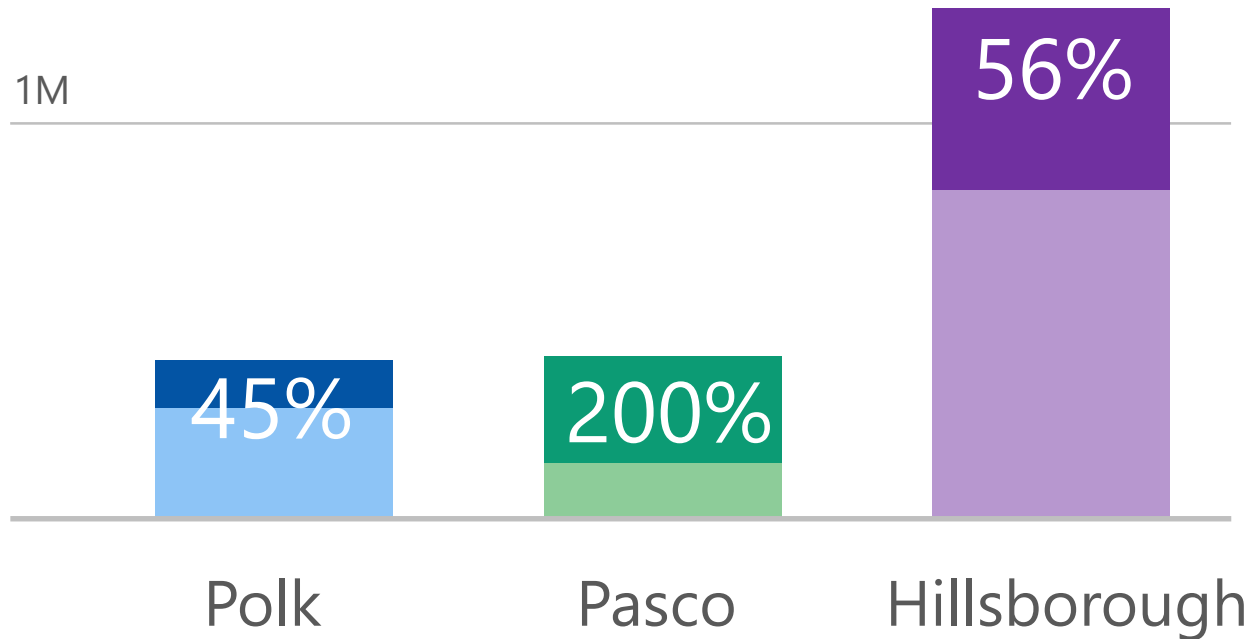



# Future Congestion

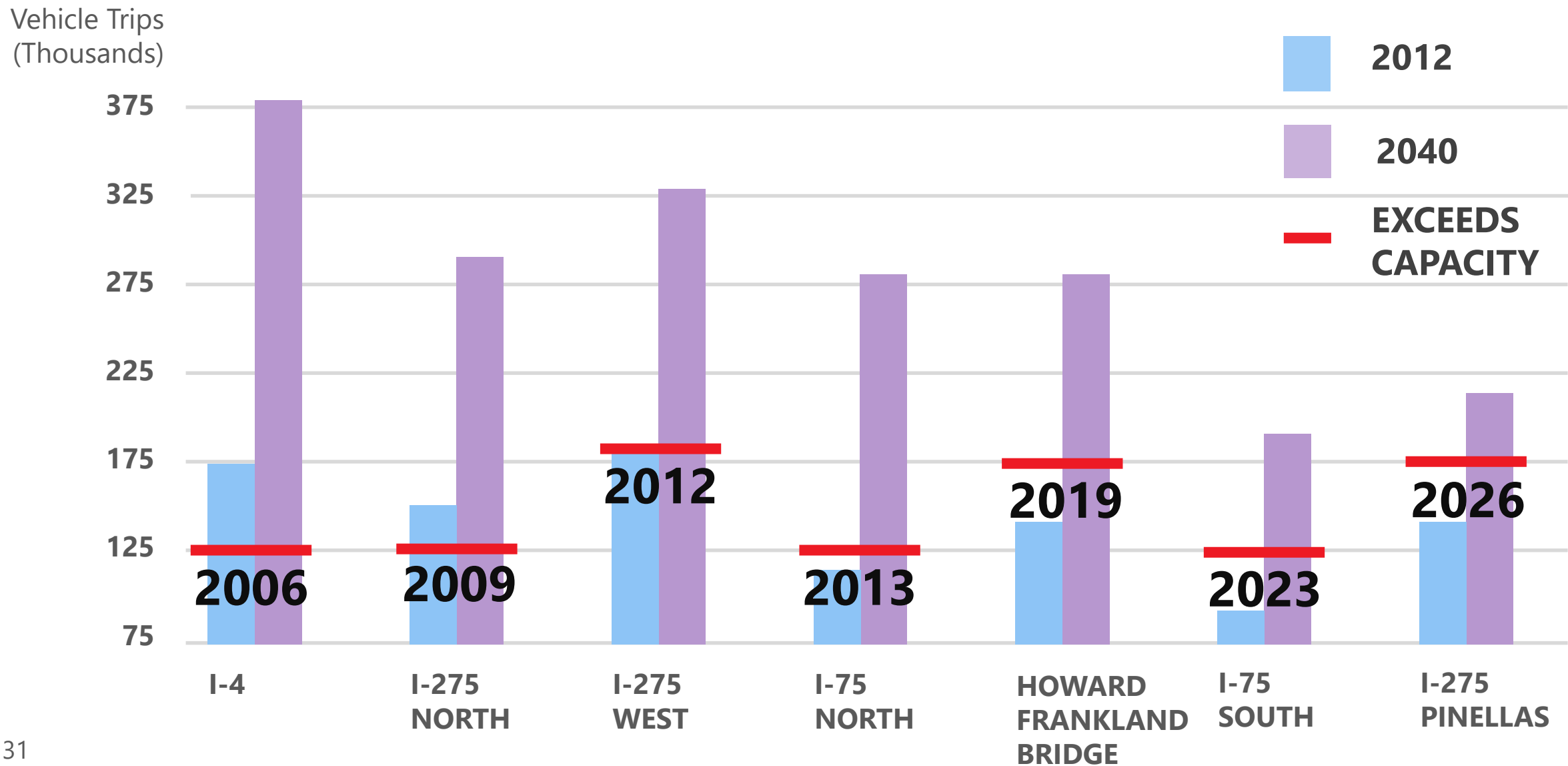



# Transit Impact on Highway Traffic



Nationwide, 5-6% of commuters take transit  
200,000 vehicles/day travel I-275 and I-4  
Even if 10% took transit (20,000 vehicles)  
We would still be CONGESTED.



**WE NEED IT ALL!!**